

# Wellbeing® Amara Sink Mixer

The Amara single lever mixer range has been designed for health, aged care as well as public spaces.

When it comes to transitioning from the familiar home environment to an unfamiliar aged care environment, it can be challenging. The Amara range of single lever mixers brings a sense of style to the independent living or aged care accommodation space helping residents feel more comfortable about their new home. Functionality that is familiar to the resident in the ensuite is of equal importance to style.

Wellbeing® Amara range - a blend of familiarity, style and function.

## FEATURES

- Highly visible colour indicators
- Easy to use, easy to hold handle design
- Metal chrome plated handle
- Easy to operate ceramic disc cartridge
- Flexibility is provided to the facility by the inclusion of handles with blue/red and blue/yellow indicators
- Low lead
- Neoperl supply hoses - robust and highly flexible

Flexibility is provided to the facility with the inclusion of 3 Star WELS (8 lpm) aerator (fitted), with 5 Star (5.5 lpm) and 6 Star WELS (3 lpm) aerators (supplied in carton).



# AMA307



Blue/Red and Blue/Yellow colour indicator handles included

## Product Codes

**AMA307** Amara Single Lever Sink Mixer

## Technical Information

Inlet Connection	15 mm (1/2" BSP)
Working Pressure Range	100 - 800 kPa*
Maximum Temperature	85°C*

\*Enware products are to be installed in accordance with the Plumbing Code of Australia (PCA) and AS/NZS3500. Installations not complying with PCA and AS/NZS 3500 may void the product and performance warranty provisions.

Reference should also be made to the Australasian Health facility Guidelines (AHFG), ABCB and Local Government regulations when considering the choice of, and the installation of these products.

NOTE: Enware Australia advises:

1. Due to ongoing Research and Development, specifications may change without notice.
2. Component specifications may change on some export models.
3. Refer to Warranty Statement for warranty details [www.enware.com.au/warranty](http://www.enware.com.au/warranty)

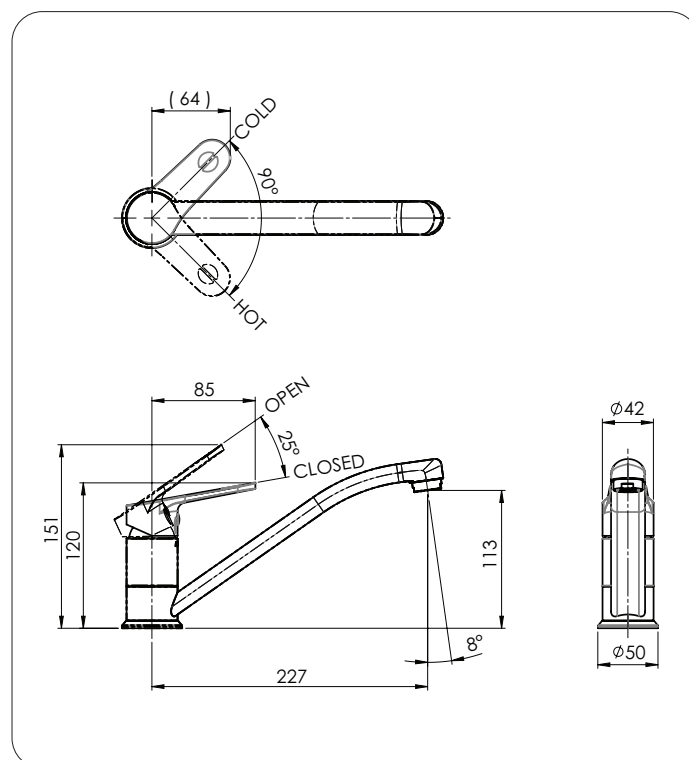

**WA DEALER**  
**PRACTICAL PRODUCTS PTY LTD**

PH: 08 9302 1299  
51 Paramount Dr Wangara WA 6065  
[sales@practicalproducts.com.au](mailto:sales@practicalproducts.com.au)  
[www.practicalproducts.com.au](http://www.practicalproducts.com.au)