

PW1C

Front-Loading Warewasher with Heat Recovery
W 680mm x D 780mm x H 2065mm

Wash Chamber
W 565mm
D 600mm
H 750mm



Washtech warewashers are built to improve the efficiency of operations washing oversized and/or heavily soiled items, from bakeries to production kitchens, supermarkets to hospitals.

The PW1C is a powerful, highly durable, simple-to-use and easy-to-maintain front-loading warewasher. It features Washtech hybrid controls which combine IP67 stainless switches, tried-and-tested switchgear, with a customisable electronic timer. Built with a large wash chamber and counterbalanced split door, the PW1C is ideal for washing bins, crates, bowls and other oversized items. The PW1C also features a highly efficient heat recovery unit which ensures minimal energy consumption and steam emissions, for even lower operating costs and an improved working environment.

Since 1981 Washtech dishwashers have been constructed from heavy-duty stainless steel, and are engineered specifically for Australian conditions and regulations. Backed by the most extensive service network and spare parts inventory in the region, your Washtech PW1C will not let you down.

Special Features

- Suitable for installation without an extraction canopy in many situations
- Integrated heat recovery unit reduces steam emissions and energy consumption and optimises for fast, efficient operation on cold inlet water

Standard Features

- Versatile 2.5, 4.5 and 6.5 minute wash cycles
- Large internal wash chamber with useable area of W 565mm x D 600mm x H 750mm
- Low water consumption of 2.6 litres per cycle
- Washtech hybrid controls
- Easy installation supplied with:
 - Water supply hose
 - Detergent and rinse aid pumps with injector lines
- Internal upper rail with optional and adjustable tines suited for hanging ladles, whisks and/or washing up to 10 baking or GN trays (up to 40mm deep) per cycle
- High powered wash system
- Suitable for connection to low inlet water pressure (break tank and rinse pump fitted)
- Heavy-duty stainless steel construction and wash manifold
- Robust stainless steel wash and rinse arms with precision stainless steel jets
- Double heavy-duty stainless steel filtration system including dual scrap trays and separate wash inlet filter
- Wash chamber easily accessible via counter-sprung split door
- Watermark approved backflow prevention
- Moffat's comprehensive 5-2-1 Warranty

Includes:

- 1 x 500mm dish rack (600 70028)
- 1 x 500mm cup rack (600 70029)
- 1 x 435mm cup cover (K0452)
- 1 x cutlery basket (C660508)
- 1 x potwasher rack grid (824 30001)
- 1 x hanging rail with adjustable tines (824 10228)



PW1C

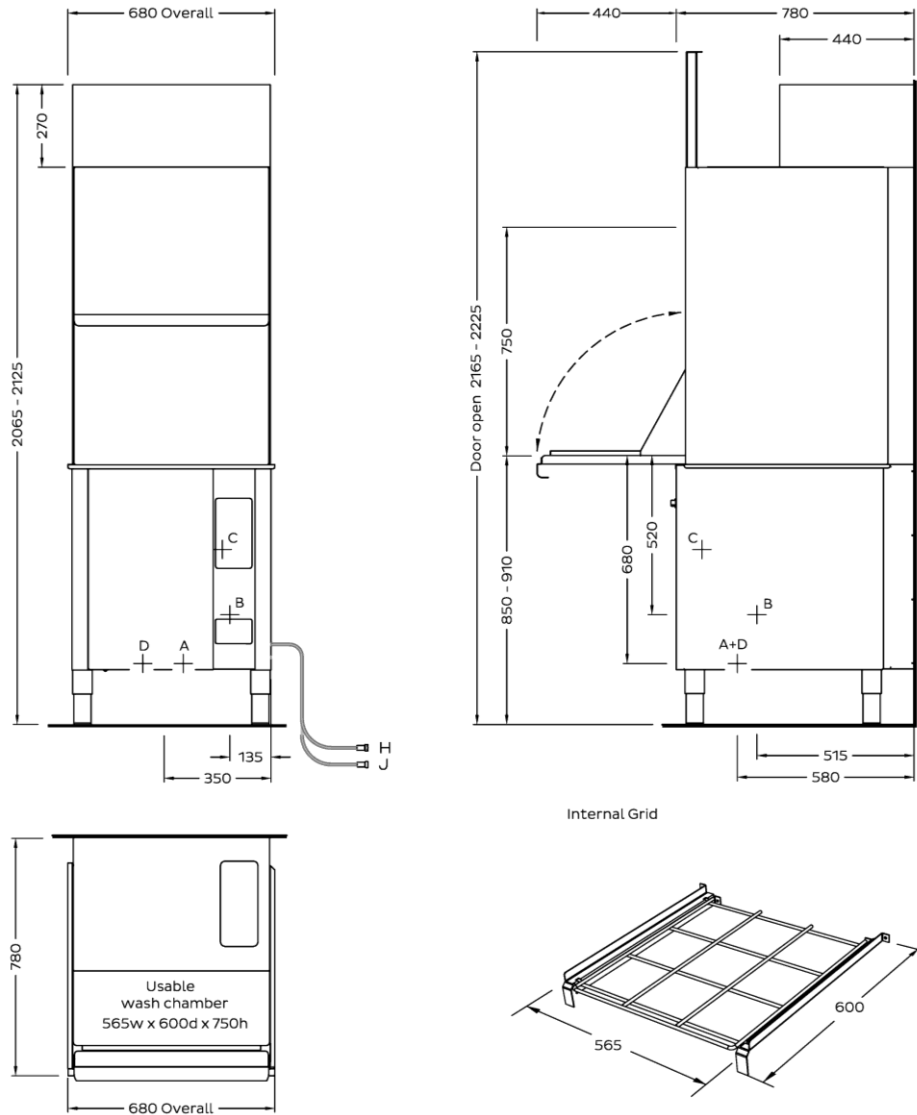

D - Cold Water

Temperature	<25°C
Connection	3/4" male; hose supplied
Pressure	100-350kPa
Flow	10 litres per min
Quality	Potable - refer table
Backflow Prevention	AVB
Consumption	2.6 litres per cycle

A - Hot Water (fill only)*

Temperature	65°C
Connection	3/4" male; hose supplied
Pressure	100-350kPa
Flow	10 litres per min
Quality	Potable - refer table
Backflow Prevention	AVB

B - Waste

Connection	1.5" BSP male
Line	2.0" / 50mm minimum

C - Electrical	V	Hz	A/phase	Max kW
Three Phase	400	50	25	18.00
Three Phase	400	50	15	10.50

Dimensions

	Machine	Packed
Width (mm)	680	770
Depth (mm)	780	870
Height (mm)	2065	2090
Weight (kg)	186	209
Volume (m³)		1.40

Water Quality

	Min	Max
pH	7	8
Hardness (ppm)	20	100
Cl-		100
SO ₄		400
Fe		0.1
Mn		0.5
Cu		0.05
Cl ₂		0.1

* Hot water recommended for faster initial heating, can be substituted for additional cold water line.

Suitable for installation without extraction canopy in most instances. Full certification from SEED available on request.

Isolating switch must be within 1m of, and not directly behind the machine.

Refer to operator manual for installation instructions.